



Supporting Discover Eumundi Heritage and Visitor Centre

Wan'din'in Arts Space at rear of Discover Eumundi Heritage & Visitor Centre (DE)

Expressions of Interest (EOI) for use March 2020 to March 2021 (closes 4 Oct 2019)
to use the Wan'din'in Arts Space are invited and are subject to the conditions outlined below:

The space is 40m2 with an outside covered area. The space has wall hanging areas with picture rail and secure wire hangers, as well as a number of plinths to display 3D work. There are clear acrylic box tops for many of the plinths to display delicate items.

See attached floor plan for dimensions of Arts Space. The space has CCTV cameras and the room has a back to base security alarm system.

Guidelines for Proposed Use of Wan'din'in

1. Use of the facility is for four weeks duration, with time allowed for bump in and out, for a cost of \$200, which includes A3 signage at the facility printed by DE (artwork provided by user). A commission of 20% will apply to all sales of work.
2. Users will curate and hang/setup their exhibition (with assistance from Discover Eumundi volunteers if required).
3. Promotional material and press releases with photographs must be provided by the user 6 weeks prior to opening and approved by the manager of Discover Eumundi.
4. Users are to be involved in publicity of their event/s and it is expected that they will be available to engage with the public, i.e. meet the artist, opening event, workshop. Discover Eumundi will promote the exhibition through its data base, social media, website, etc and users are expected to do the same
5. Users must have an opening event for their exhibition and are responsible for catering this and any other events. A cash bar will be supplied and staffed by Discover Eumundi volunteers, with all proceeds going to Discover Eumundi.
6. **If successful**, any changes to the proposed title/theme of the exhibition **must** be negotiated with the Manager of DE.

Proposal Assessment and Criteria Guidelines:

- Residents of Sunshine Coast/Noosa region will be given preference
- New work not exhibited within the Sunshine Coast/Noosa region will be given preference.
- Contemporary art theme relevant to current social and environmental issues
- Ability for exhibition to be mounted in the space available (all 2D artwork must be ready to hang)
- Willingness to engage with community e.g. providing artists' talks or workshops
- Leaflets and invitations are to be designed and printed at user's cost

I have read and understood the above.

Yes

Box must be ticked/crossed to proceed

Signature/s

Date

Expression of interest to use Arts Space

Name of main contact: _____

Address: _____

Contact Phone number/s Mobile: _____

Home: _____

Email: _____

Website/Facebook Page: _____

Proposed Title for Exhibition: _____

Brief description of exhibition/event within the Proposal Assessment Guidelines:

Does your work have a theme? If so please describe below the theme of proposed work, whether work is contemporary and/or conceptual. The artworks, when more than one artist should be of a cohesive nature.

3D or 2D work (mark which is applicable).

Please attach separate sheet if insufficient space.

Names and email contact of additional artists and/or artisans involved

Your preferred month between March 2020 and March 2021: _____

Please attach/include a brief CV for each artist and include websites or other links where images of previous work can be viewed or email images (up to 10) when sending in this form

Email all documents regarding the EOI process to: info@discovereumundi.com or post to Discover Eumundi PO Box 427 Eumundi Qld 4562.

All EOIs will be assessed by the Eumundi Historical Association Management Committee who are responsible for DE and Wan'din'in Arts Space. You will be notified by email of the outcome.

Please note: additional information may be required and/or a meeting may be necessary with you to finalise the assessment and inclusion of your application as part of this EOI process.

Floor Plan of Wan'din'in

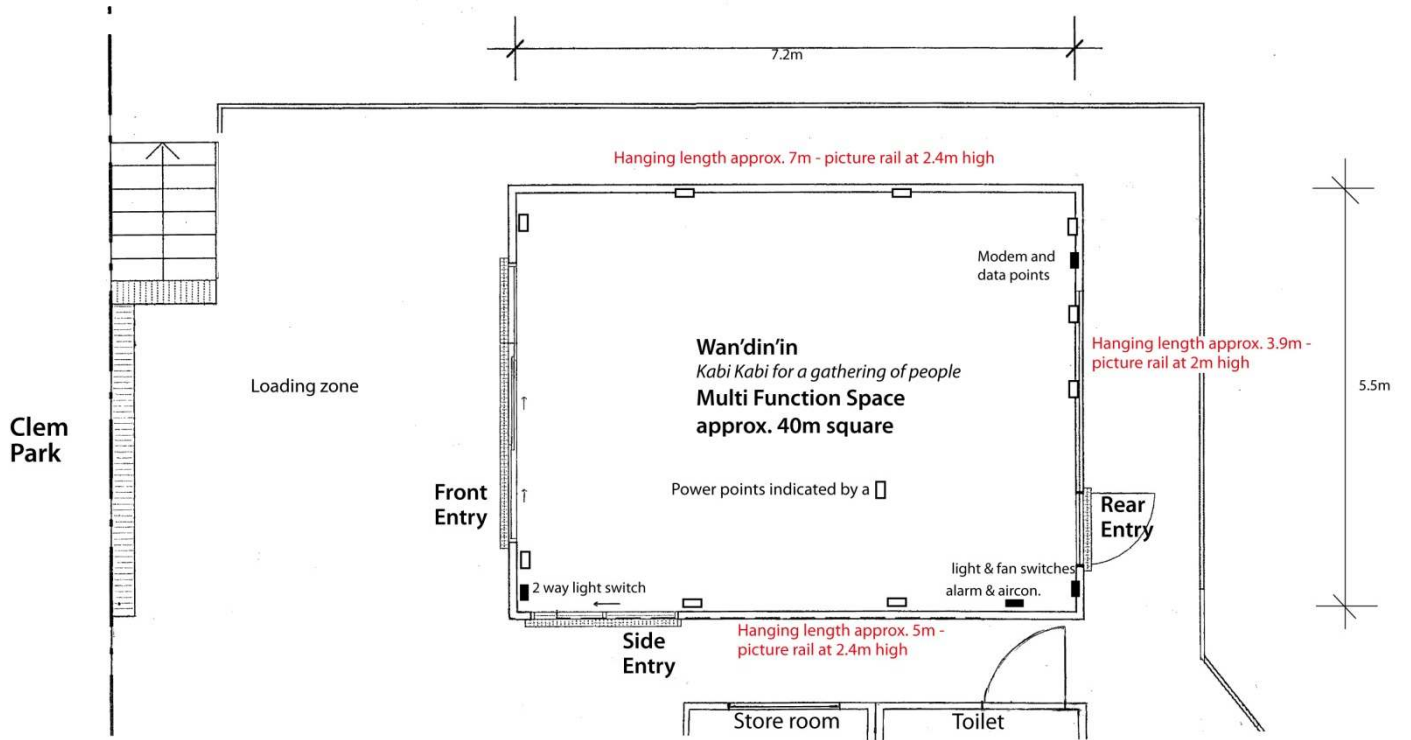

Discover Eumundi Main building



Photo taken in direction of front entry